

Quick Setup Guide

1 Connect the 2talk Adapter

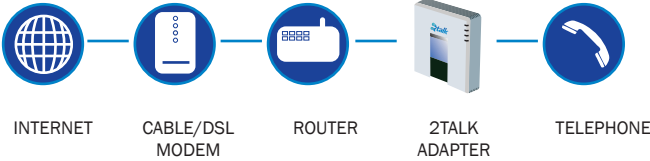

A Connect the included Ethernet network cable to the INTERNET port of the adapter.

Connect the other end to one of your router's Ethernet ports.

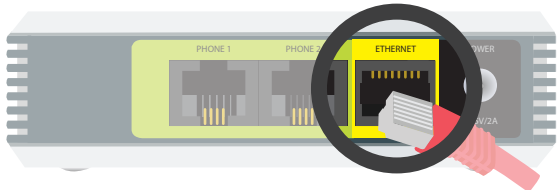

B Connect the included power adapter to the POWER port of the adapter.

Connect the other end to an uninterrupted power supply (UPS), surge protector, or 110V electrical outlet.

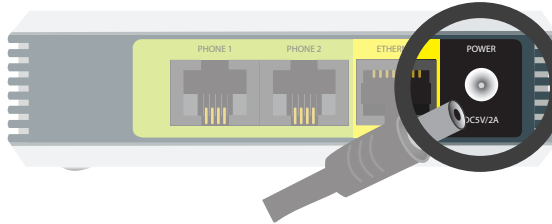

C Using a telephone cable, connect your touch-tone telephone to the PHONE 1 port of the adapter.

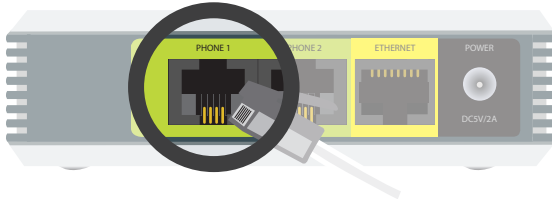

D If you have a second 2talk account, then connect another telephone or a fax machine to the PHONE 2 port of the adapter.

E The Power and Phone LEDs will be solidly lit when the adapter is ready for use. The Internet LED will blink intermittently during normal use.

F You are now setup to make calls using your 2talk service. Please refer to the reverse side for setting up your Voicemail Auto Attendant and other features.

Remember to set up all of your calling features using the Quick Start Guide!

2 Troubleshooting

A If the 2talk adapter is not working, the first step is to power OFF each of the following in this order:

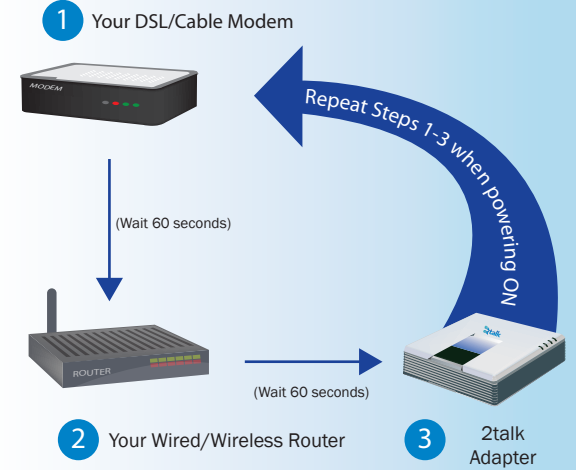

B Pick up the phone and wait for a dial tone. If there is no dial tone or the problem persists, please contact support at ussupport@2talk.com

Share and Save!

For every customer you refer to 2talk that signs up, you get a discount off your bill!

Visit 2talk.com/share to start sharing!